

## DT-IPG Test QSG

Quick view of new function of DT-IPG

### Connection:

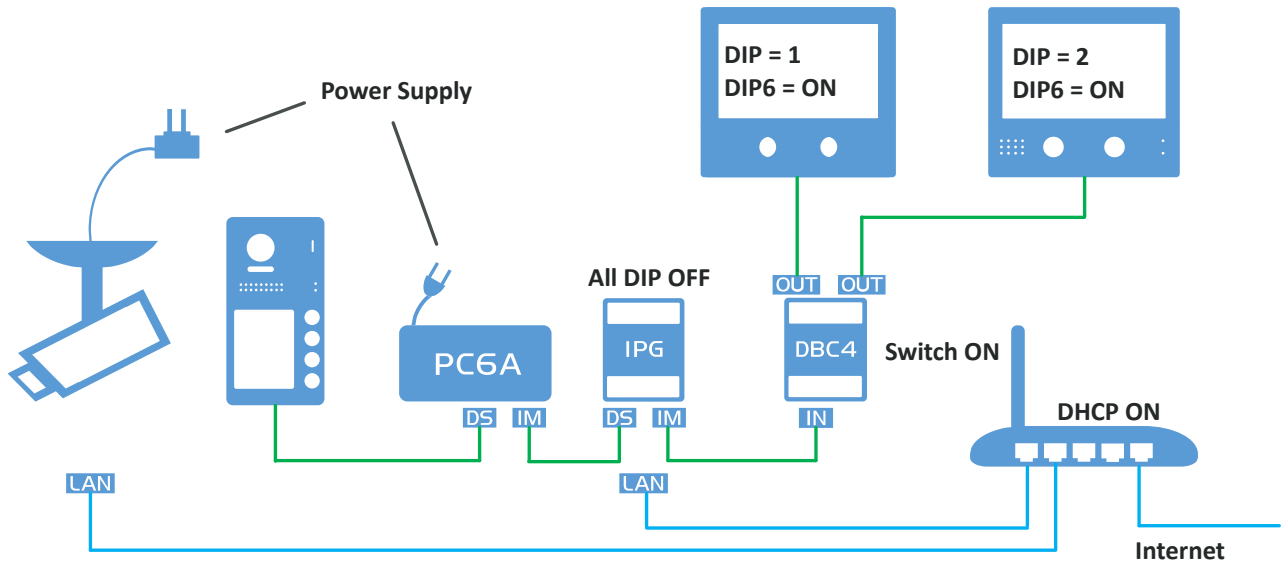

### Devices

Devices and requirement as below:

Device	Camera	DT-IPG	Power	Distributor	Monitor	Panel	Router
<b>Require</b>	Configured ONVIF Camera	Updated DT-IPG	PC6A Or PC6B	Distributor	Updated DT433 DT437 DT17S DT471	Any 2-Wire Door Panel	Router With DHCP ON

**IP Camera:** Configured ONVIF Camera. (access:admin/admin,sub-stream: H.264 Baseline QVGA).

**DT-IPG:** Updated DT-IPG. **ALL DIP OFF** (Dynamic IP Address), with/without SD card

**Power:** PC6A/PC6B or PS5+DPS.

**Distributor:** DBC4A1 or DBC4R(distributor mode)

**Monitor:** Updated DT433/DT437/DT17S/DT471, **In Address 01 and 02**

**Panel:** Any 2-Wire Door Station, villa or apartment.

**Router:** With Internet access and enable DHCP.

**Mobile:** with 2Easy and connect with 4G network.

## Power ON, memory function check

Wait until DT-IPG "Power" LED from flash to solid on

And check with below indictator, wait led state as below, then move to next step.

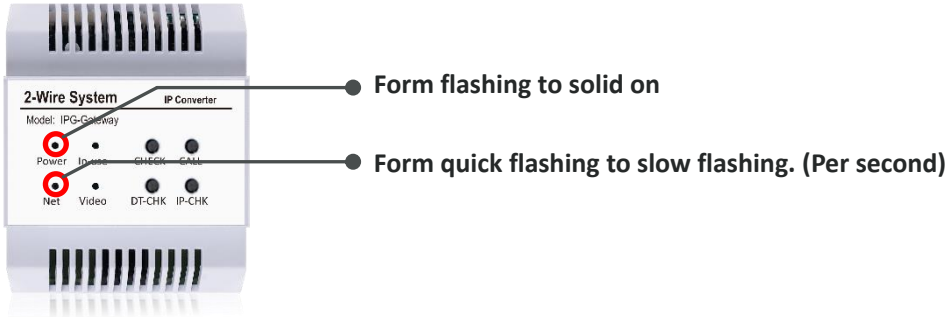

Press call button to call monitor. Check on monitor, in 5<sup>th</sup> second, monitor display with "•" or "•REC".

Check video/picture reocrd on monitor as below:

**DT471:**

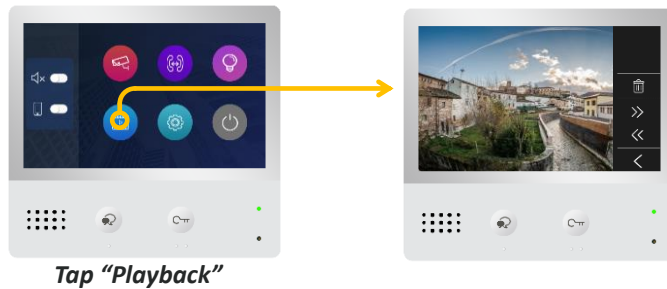

**DT437:**



**DT433/DT17S(same setting, take DT17S as example):**



\*DT433 and DT17S settings procedure is same.

## Link to IP Camera and check

Long press “IP-CHK” until “In-Use” light up, release “IP-CHK” immediately (otherwise it will goes to update procedure), “Net” will flashes means DT-IPG is searching and linking to IP cameras, when is finish, all LED will flash once

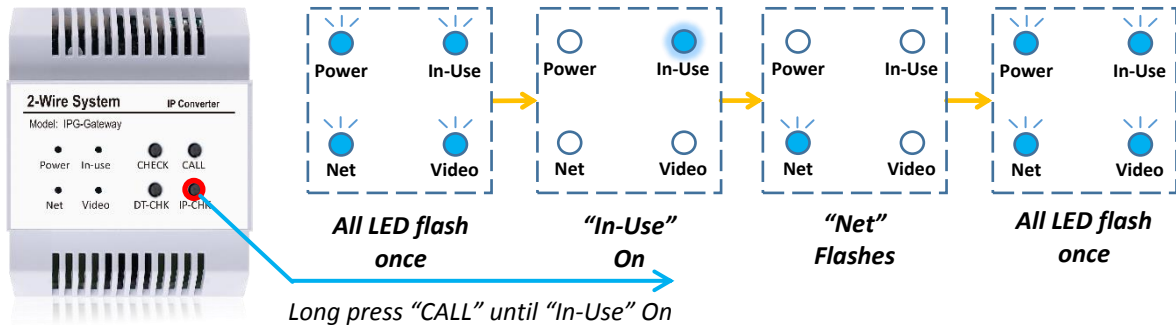

To check IP Camera on Monitor as below:

**DT471:**



**DT437:**

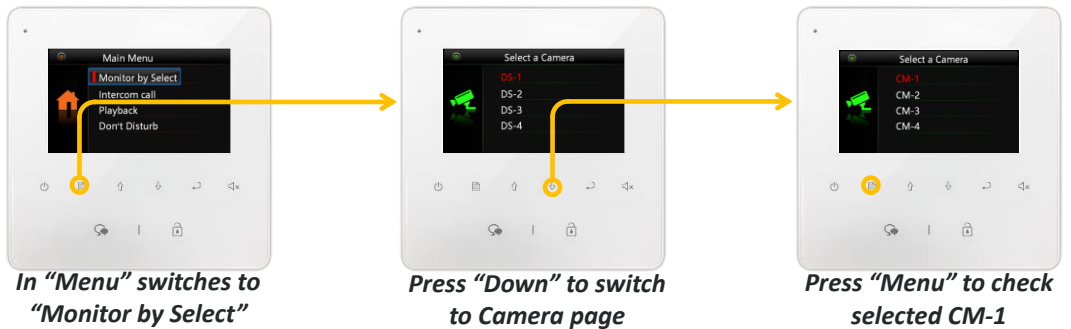

**DT433**

**DT17S**

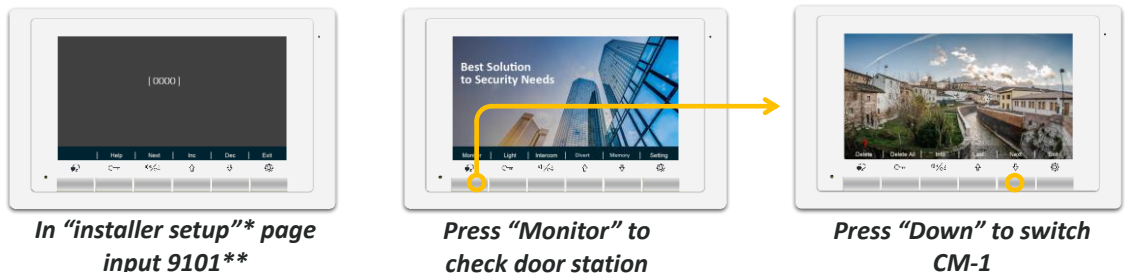

\*On DT17S/DT433, “Settings” -> switch to “About” -> Long press “Unlock” to go into “Install setup” page

\*\*Set up DS quantity, input code 9101~9104, means 1~4 door stations. 9101 means one door station

\*\*\*DT433 and DT17S settings procedure is same.

## Switch to Camera during calls.

Switch to camera during calls and keep communicating with door stations.

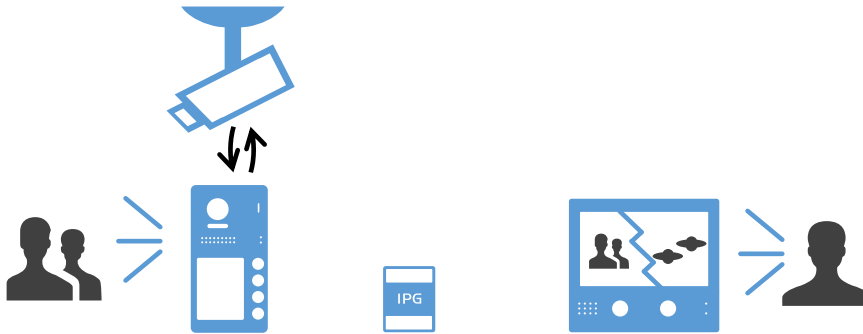

**To switch cameras during call as follow:**

First make a call to monitor, and during calling to switch to cameras

**DT471:**



*Tap "Camera"*



*Tap "Next Page"*



*Tap "CM-1 to check CM-1"*

**DT437:**



*Press "Down" to switch to camera*



*Press "Down" to switch back to door station*

**DT433**

**DT17S**



*In "installer setup"\* page input 9101\*\**

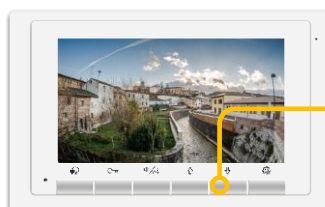

*Press "Down" to switch to Camera*

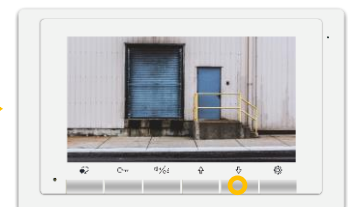

*Press "Down" to switch back to door station*

*\*On DT17S/DT433, "Settings" -> switch to "About" -> Long press "Unlock" to go into "Install setup" page*

*\*\*Set up DS quantity, input code 9101~9104, means 1~4 door stations. 9101 means one door station*

*\*\*\*DT433 and DT17S settings procedure is same.*

## Divert calls to mobile

### Setup Divert and get QR code for login

To enable divert on monitors which connected with DT-IPG, please check with below procedure, also shows how to get QR code for 2Easy APP to scan and login

**DT471:**



✚ If turn on "Do not Disturb" (red arrow) with "Divert" at same time, monitor will divert immediately, if only "Divert" is turn on, monitor will divert if no answer on the monitor.

**DT437:**

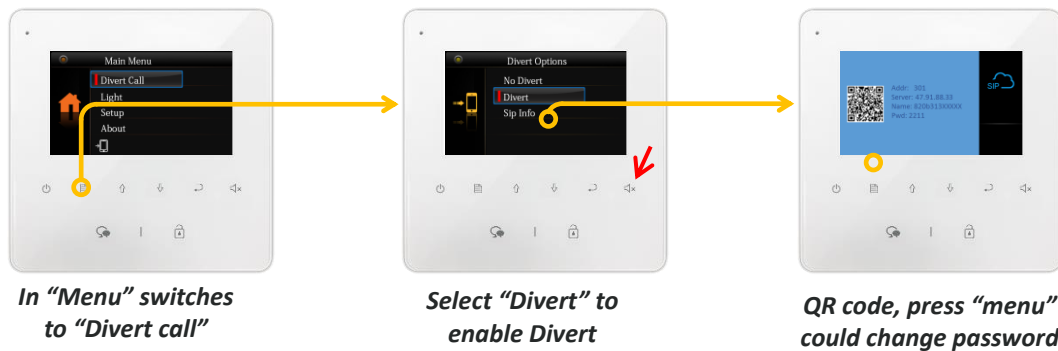

✚ If turn on "Do not Disturb" (red arrow) with "Divert" at same time, monitor will divert immediately, if only "Divert" is turn on, monitor will divert if no answer on the monitor.

**DT433/DT17S(same setting, take DT17S as example):**

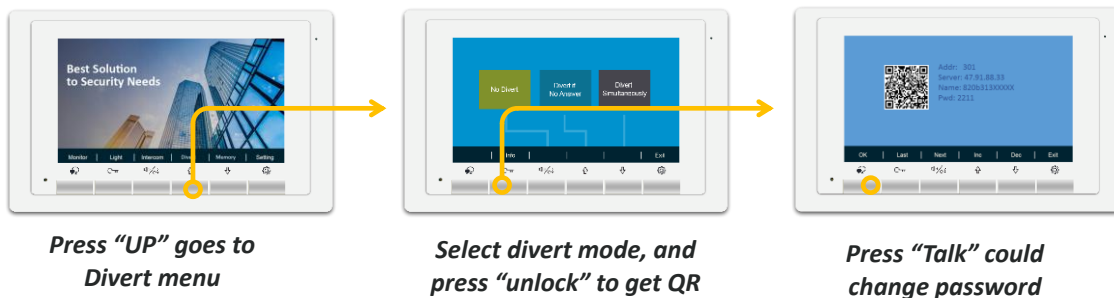

\*DT433 and DT17S settings procedure is same.

## Download Setup 2Easy APP

- 1) Scan and download 2Easy APP, or search “2Easy” on APP store. Android version is temporary test version, and is not available on Google play yet.



- 2) Permit “2Easy” with internet access and camera, on DX monitor, tap “SIP Server” icon on main menu, and keep in “SIP config”, on 2Easy APP, tap on top-right, to scan QR code on monitors, and tap “Save”.

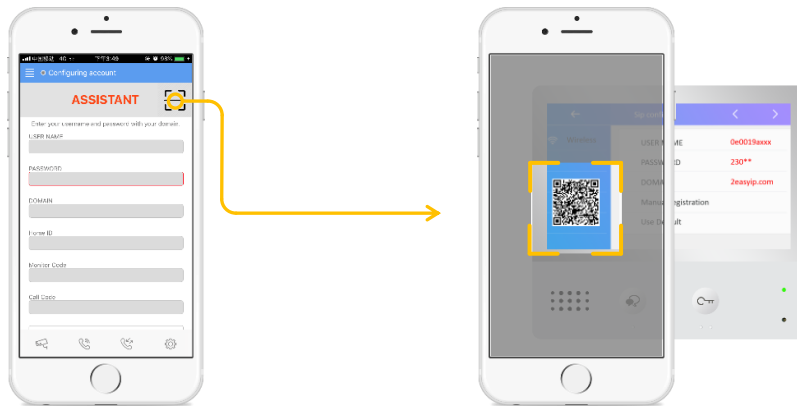

- 3) Disable “IPV6” on 2Easy APP

Most of internet provide doesn’t support IPV6 feature, please manually disable it with follow steps: Goes to “menu” page -> “Settings”-> “Network” -> disable “Allow IPV6”, as below shows.

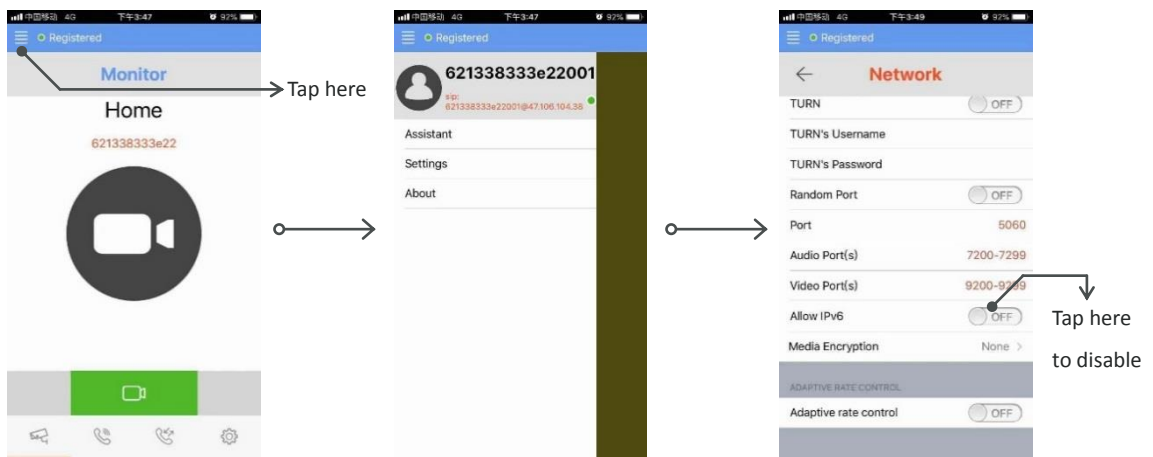

- 4) After login SIP account on 2Easy APP, check on status bar, or tap on the “Registered” area to manually register, until 2Easy APP display:

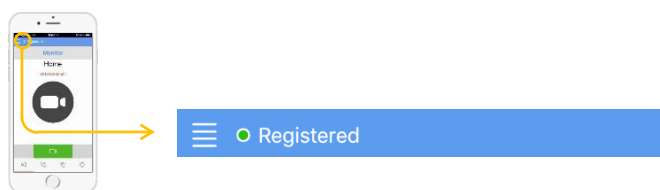

## Special case

DT-IPG could also works without Internet, still could test with IP camera and memory function. Could connect with multi cameras, please notice words in "RED" means settings are changed.

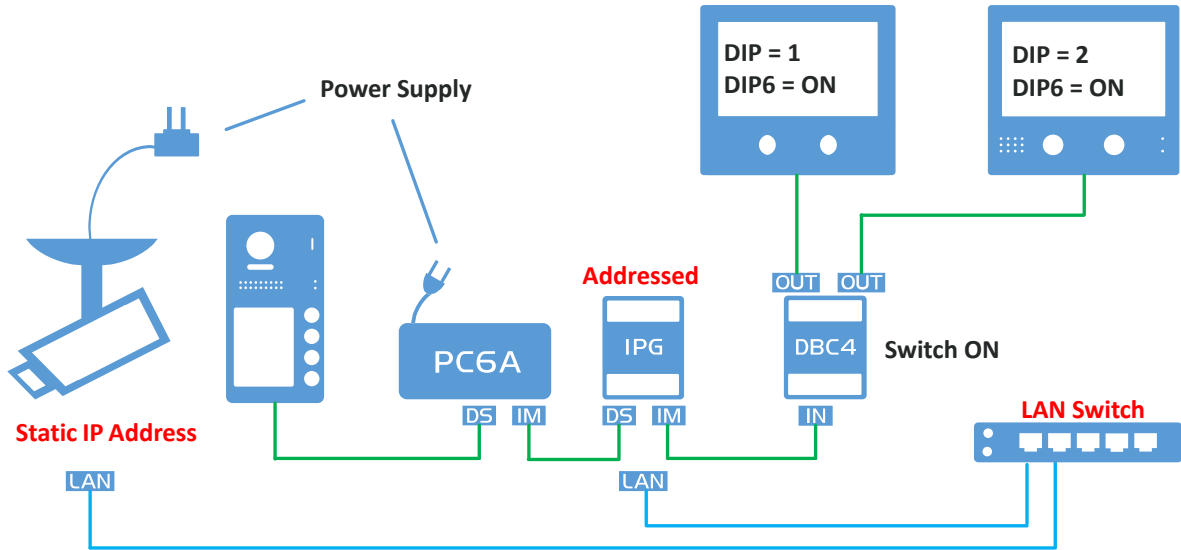

Or 1 Camera directly to DT-IPG

